



**Electrolux**

## Digital Undercounter Refrigerated Counter Saladette - 66 gal (250 lt) 2 Door with lid and chopping board

ITEM # \_\_\_\_\_

MODEL # \_\_\_\_\_

NAME # \_\_\_\_\_

SIS # \_\_\_\_\_

AIA # \_\_\_\_\_



Electrolux



### Digital Undercounter

### Refrigerated Counter Saladette - 66 gal (250 lt) 2 Door with lid and chopping board

728627 (SAL25L2C9)

Refrigerated Counter  
Saladette - 66 gal (250 lt) 2  
Door with lid and chopping  
board- 230 V/1N/50Hz

### Short Form Specification

#### Item No.

Constructed entirely in 304 AISI stainless steel. High-density expanded polyurethane foam, 50 mm in thickness, with cyclopentane injection. Height-adjustable feet. Hinged lid on top. Lower refrigerated compartment designed to accommodate GN 1/1 containers and equipped with N. 2 hinged doors. Built-in refrigeration unit. Ventilated. Refrigerant R134a. Digital control panel. Automatic evaporation of defrost water. Suitable to operate in ambient temperatures up to +32°C. Temperature range: +2/+10°C. CFC and HCFC free.

Supplied with n.9 horizontal container supports and n.1 non-toxic plastic chopping board.

### Main Features

- Suitable for use in ambient temperatures of up to 32 °C.
- Adjustable temperature range from 2 °C to 10 °C to suit meat, fish and dairy storage requirements.
- Anti-tilt runners accept GN 1/1 containers.
- Digital control panel.
- Forced air circulation for rapid cooling and an even temperature distribution.
- CFC and HCFC free (ecological refrigerant type: R134a, - gas in foam: cyclopentane).
- 60 mm insulation for energy saving.
- Equipped with hinged lid for non-operating periods.
- Automatic evaporation of defrost water.

### Construction

- Mounted on legs with height adjustment.
- Built-in compressor to suit operating conditions.
- Constructed from AISI 304 Stainless steel throughout to meet the highest hygiene standards.
- Rounded internal corners for ease of cleaning.
- Access to all components from the front.
- Developed and produced in ISO 9001 and ISO 14001 certified factory.

### Optional Accessories

- 1/1GN grey rilsan grid PNC 881435 ☐
- 1/1GN plastic container h=100mm PNC 811451 ☐
- 1/1GN plastic container h=150mm PNC 881040 ☐
- 1/1GN plastic container h=65mm PNC 881038 ☐

APPROVAL: \_\_\_\_\_



Electrolux

**Digital Undercounter  
Refrigerated Counter Saladette - 66 gal  
(250 lt) 2 Door with lid and chopping  
board**

**Front**

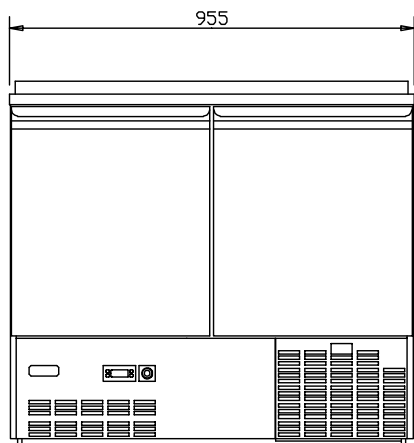

**Top**

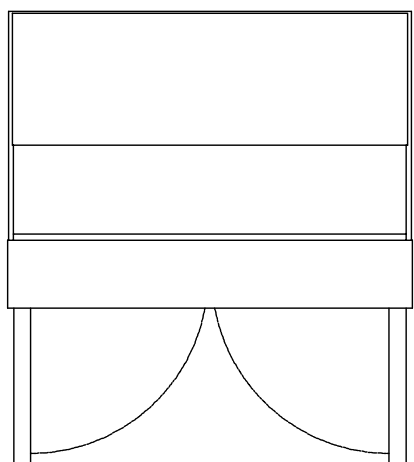

**EI** = Electrical connection

**Side**

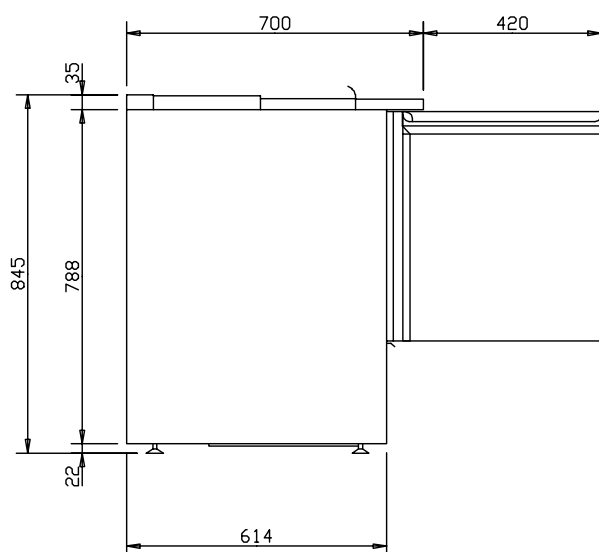

**Electric**

Supply voltage:

728627(SAL25L2C9)

230 V/1N ph/50 Hz

**Key Information:**

Door hinges: 1 Left+1 Right

**Built-in Compressor and Refrigeration Unit**

External dimensions, Height: 845 mm

External dimensions, Width: 955 mm

External dimensions, Depth: 700 mm

Number and type of doors: 2

Depth with doors open: 1120 mm

Number and type of grids  
(included): - GN 1/1

**Refrigeration Data**

Compressor power: 1/4; hp

Refrigerant type: R134a

Refrigeration power: 224 W

Refrigerant weight: 120 g



**Digital Undercounter  
Refrigerated Counter Saladette - 66 gal (250 lt) 2 Door with lid and  
chopping board**  
The company reserves the right to make modifications to the products  
without prior notice. All information correct at time of printing.

2013.01.10