



Electrolux

Digital Cabinets 400lt Line Freezer 1 Glass Door (White)

ITEM # _____

MODEL # _____

NAME # _____

SIS # _____

AIA # _____



Electrolux



Digital Cabinets

400lt Line Freezer 1 Glass Door (White)

730159 (R04FSGGW)

1-glass door freezer,
400lt, -15-22°C, white

Short Form Specification

Item No. _____

External in white prepainted steel. Internal in white thermoformed polystyrene which is impact resistant with rounded corners.

Insulation thickness mm45. Grid runners are thermoformed and incorporated in the inner structure. Right hinged glass door with lock and heated frame. Static operating mode; mechanical control; evaporating grids; manual defrost with waste water device; internal lighting. For ambient temperatures up to 32 °C. CFC and HCFC free. R404a gas in refrigeration circuit. Gas in foam: Cyclopentane.

Supplied with evaporating grids.

Main Features

- Digital control panel allowing the easy and precise setting and control of the internal temperature.
- Shelf runners are thermoformed and are incorporated in the internal structure to be easily cleanable.
- Model requires only 1 phase 220/240V supply and can be plugged straight into an existing power socket.
- Very quiet operation.
- Whole interior cell with rounded corners is white thermoformed polystyrene, which is impact resistant.
- No joints whatsoever to eliminate dirt traps.
- Simple refrigeration system easily accessible from the rear of the units.
- Suitable for use in ambient temperatures of up to 32 ° C.

Construction

- Developed and produced in ISO 9001 and ISO 14001 certified factory.
- All models in range are finished in top quality materials to aid durability.
- CFC and HCFC free (ecological refrigerant type: R404a, - gas in foam: cyclopentane).

Optional Accessories

- Printer for HACCP basic version (for cabinets and counters with digital control) PNC 881457 ☐

APPROVAL: _____



Electrolux

Digital Cabinets 400lt Line Freezer 1 Glass Door (White)

Front

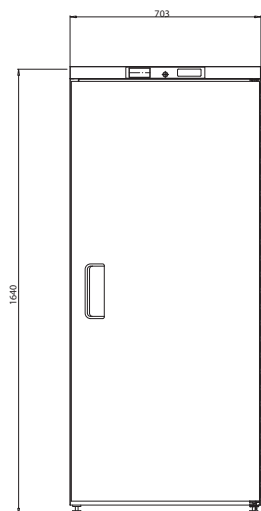

Top

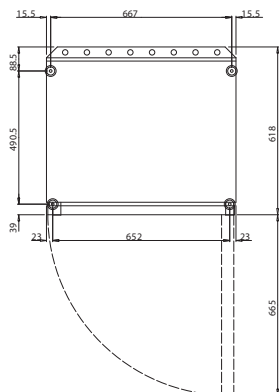

EI = Electrical connection

Side

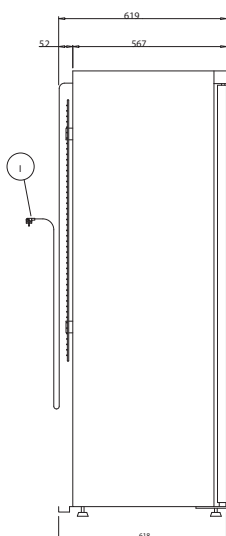

Electric

Supply voltage:

730159(R04FSGGW)

230 V/1N ph/50 Hz

Connected load:

0.85 kW

Key Information:

Door hinges: Right Side

External dimensions, Height: 1645 mm

External dimensions, Width: 703 mm

External dimensions, Depth with Doors Open: 1310 mm

Gross capacity: 400 lt

Noise level: 56 dBA

Number and type of grids (included): - 600x400

Type of external material: Prepainted Steel

External door material: Glass Heated

Refrigeration Data

Control type: Digital

Compressor power: 1/2 hp

Refrigerant type: R404a

Refrigeration power: 628 W

Refrigeration power at evaporation temperature: -23 °C

Refrigerant weight: 240 g

Operating temperature min.: -22 °C

Operating temperature max.: -15 °C

Operating mode: Static

Cooling unit: Built-In

Defrost type: Manual



Digital Cabinets
400lt Line Freezer 1 Glass Door (White)

The company reserves the right to make modifications to the products without prior notice. All information correct at time of printing.

2012.09.28