

700XP

Electric Hob Cooking Tops

The 700XP range is comprised of over 100 models designed to guarantee the highest level of performance, reliability, energy saving, safety standards and ergonomic operation. These concepts are reflected throughout the line in its modularity, construction and numerous configurations: countertop (on base or table), free-standing, on concrete or stainless steel plinth, bridged or cantilever. Thanks to its advance technology and premium performance, 700XP is a perfect solution for institutions of small sizes with limited footprint as well as restaurants needing to obtain the most from the kitchen space. The models detailed in this sheet are electric hob cooking tops.

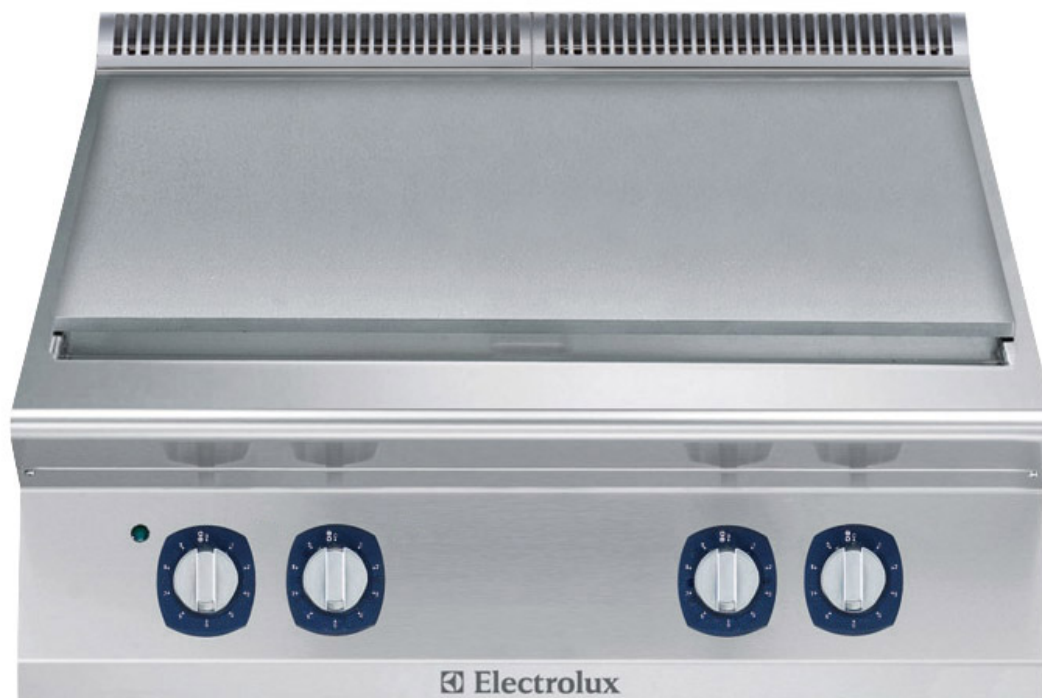

EASY TO INSTALL

- Main connections are accessible from the back of the unit.
- Access to all components from the front.
- Provided with a service duct to facilitate installation and can be mounted on table tops, open base cupboards, bridging or cantilever supports.

EASY TO CLEAN

- One piece pressed worktop in 1,5mm stainless steel with smooth, rounded corners.
- Exterior panels in stainless steel with Scotch Brite finish.
- All models have right-angled, laser cut side edges to allow for the flush-fitting of units side-by-side thus eliminating gaps and possible dirt traps.

EASY TO USE

- The electric solid top is ideal for kitchens needing a flexible and powerful cooking top. It allows the chef to easily move pots and pans from one area of the cooking surface to another without the need of lifting.
- Infrared heating elements with maximum temperature of 400 °C on the cooking surface.
- Pans can easily be moved from one area of the cooking surface to another without the need of lifting.

EASY TO MAINTAIN

- IPX4 water protection.
- The special design of the control knobs and bezels guarantees against water infiltration.

EASY ON THE ENVIRONMENT

- 98% recyclable by weight.
- CFC free packaging.



Electrolux

700XP
Electric Hob Cooking Tops

	E7HOED2000 371027	E7HOEH4000 371028
TECHNICAL DATA		
Power supply	Electric	Electric
External dimensions - mm		
width	400	800
depth	730	730
height	250	250
Power - kW		
installed-electric	5	10
Net weight - kg.	47	90
Supply voltage	400 V, 3N, 50/60	400 V, 3N, 50/60
ACCESSORIES		
2 SIDE COVERING PANELS H=250-D=700-ELUX	216277	216277
CHIMNEY UPSTAND 400MM	206303	
DRAUGHT DIVERTER WITH 150 MM DIAMETER		206132
FRONTAL HANDRAIL 1200 MM	216049	216049
FRONTAL HANDRAIL 1600 MM	216050	216050
FRONTAL HANDRAIL 400 MM	216046	
FRONTAL HANDRAIL 800 MM	216047	216047
JUNCTION SEALING KIT	206086	206086
LARGE HANDRAIL(PORTIONING SHELF)400 MM	216185	
LARGE HANDRAIL(PORTIONING SHELF)800 MM	216186	216186
MATCHING RING FOR FLUE CONDENSER 150DIAM		206133
SIDE HANDRAIL-RIGHT/LEFT HAND-700 LINE	206307	206307
STAND/SUPPORT 400 MM	206183	
STAND/SUPPORT 800 MM		206184
SUPPORT FOR "BRIDGE" SYSTEM 400 MM	206154	
SUPPORT FOR "BRIDGE" SYSTEM 800 MM		206137
WATER COLUMN EXTENSION FOR 700 LINE	206291	206291
WATER COLUMN WITH SWIVEL ARM	206289	206289

CHBC010

2012-06-25

Subject to change without notice

700XP
Electric Hob Cooking Tops

371027

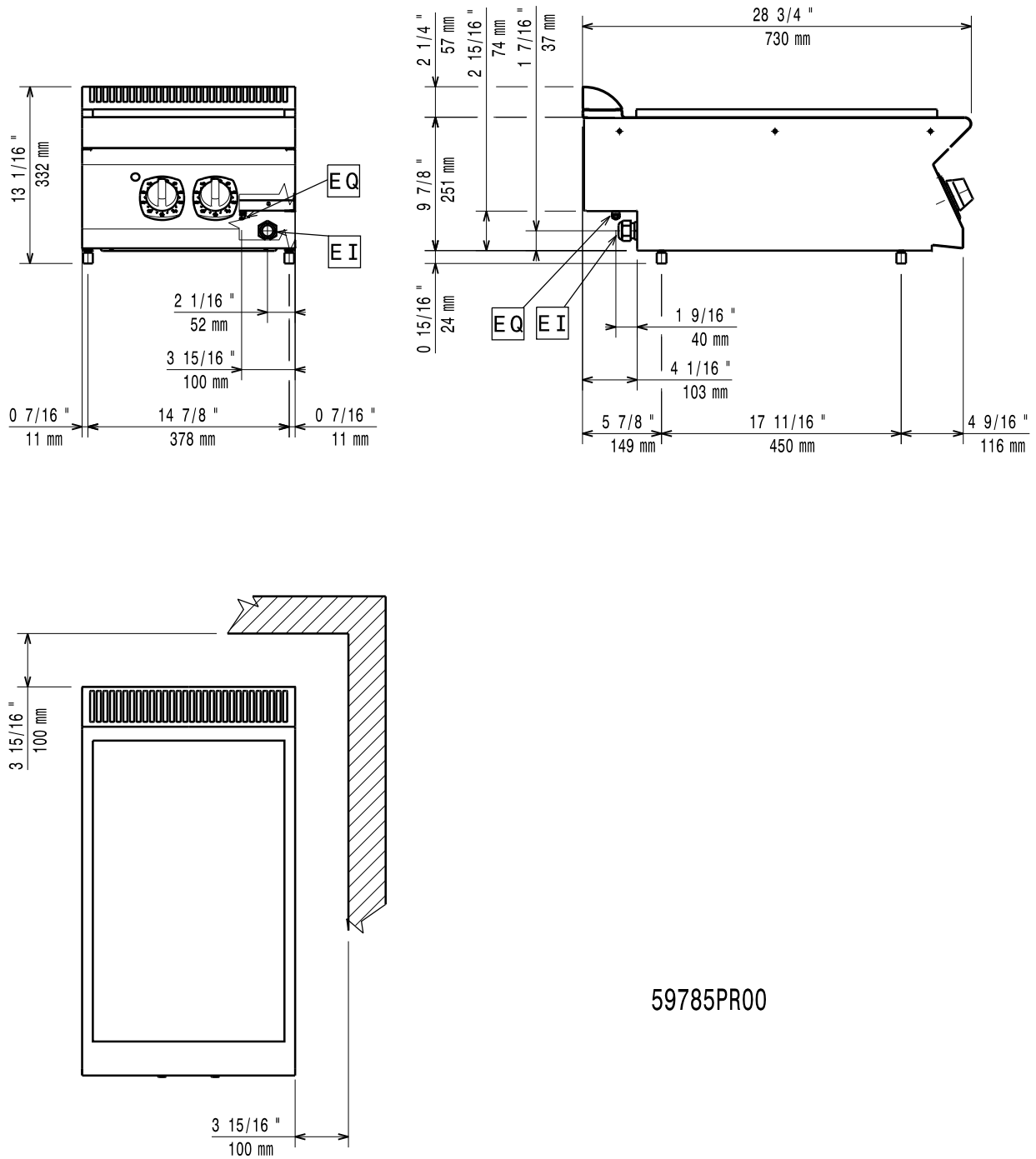

59785PR00

CHBC010

2012-06-25

Subject to change without notice

LEGEND

EI - Electrical connection

E7HOED2000
371027

400 V, 3N, 50/60

700XP
Electric Hob Cooking Tops

371028

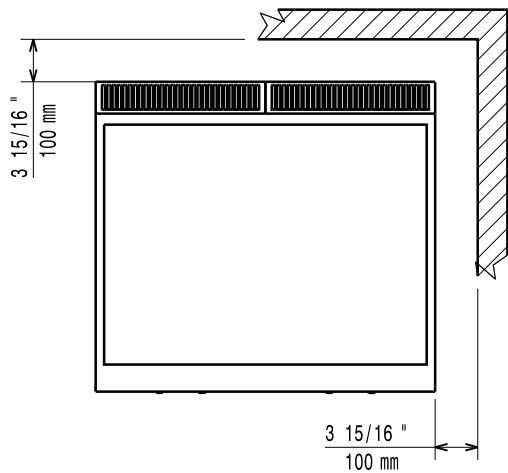
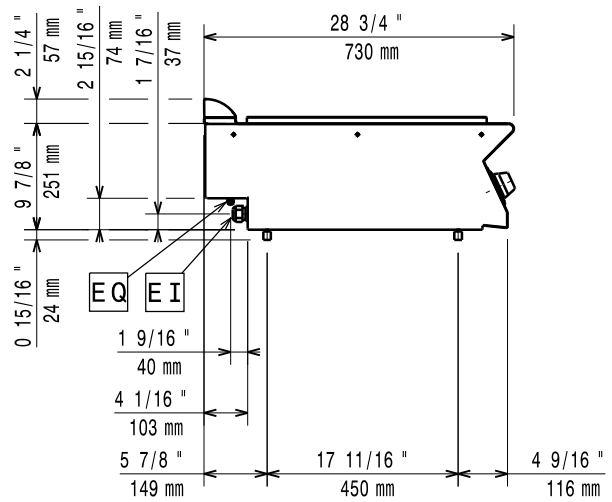
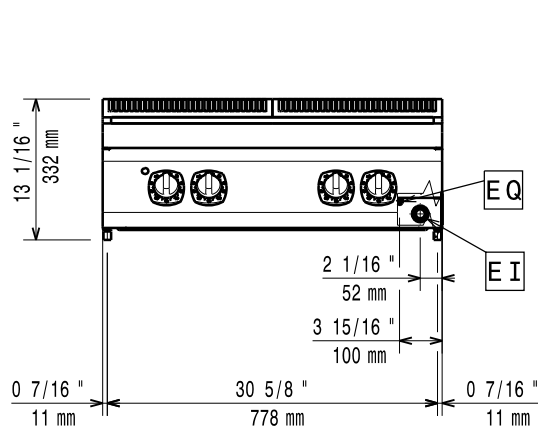

59785PS00

CHBC010

2012-06-25

Subject to change without notice

LEGEND EI - Electrical connection	E7HOEH4000 371028
	400 V, 3N, 50/60